

(M-9032-30, M-9032-36, M-9032-48)

Document Shelf Box Contents:

Document Shelf
2 x Brackets

Document Shelf Assembly:

- * Place Document Shelf on Upright in desired location
- * Place one side of bracket through the front side of shelf
- * Slide the second bracket over first bracket straddling upright.
- * Tighten star bolt.
- * Repeat for other side.

NOTE: DO NOT DISCARD PACKAGING MATERIAL UNTIL ALL CONTENTS ARE LOCATED

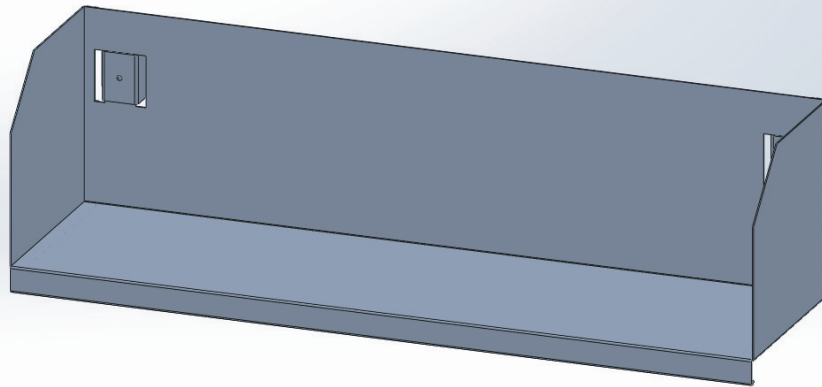

FRONT SIDE

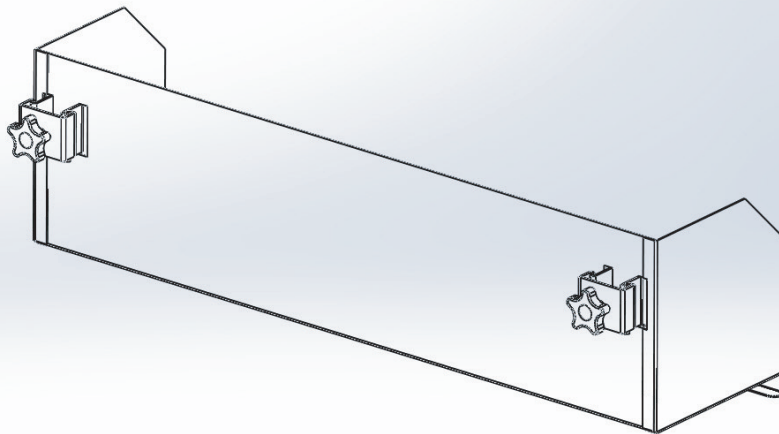

BACK SIDE